

23mm Round Tube Towel Rail Fitting Instructions

Steel Towel Rail 23mm Round Tubes

Please read these instructions and terms and conditions carefully prior to installation. Failure to do so may invalidate the warranty.



Cod. 1589M0925

1. Unpack & Inspect

This product should have reached you in perfect condition. Please carefully unpack and inspect this towel rail and all fittings. Your point of purchase must be notified of any shortages or damage within 28 days of delivery.

Pipe Centres

- Pipe centres left to right = width - 30mm
- Pipe centres from wall = 70mm - 85mm
- Depth from wall = 85mm - 100mm

2. Contents

- You should have:
- 1 Towel Rail
 - 4 Wall brackets (in parts)
 - Bracket Sleeve x 4
 - Bracket Body x 4
 - Bracket Head x 4
 - Bracket Head Allen Screws x 4
 - Bracket Cap x 4
 - Grub Screw x 4
 - Wall plugs & screws x 4

- You will need:
- Tape measure
 - Electric drill & bits
 - Spirit level
 - Screwdrivers
 - 3mm Allen Key

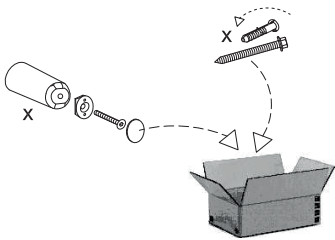

3. Bracket Positioning

Fig 1.

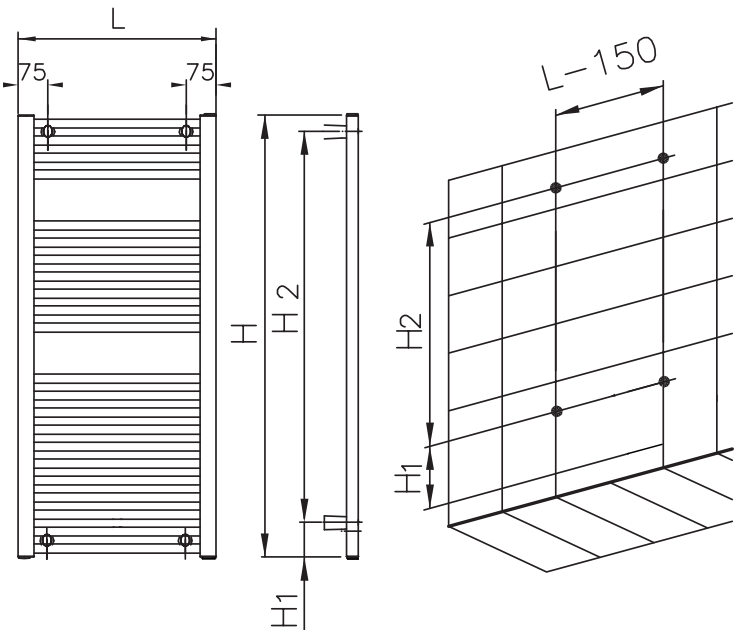

L (mm)	L-150 (mm)	H (mm)	H2 (mm)	H1 (mm)
500	350	818	731	43
500	350	1118	1031	43
500	350	1462	1375	43
580	430	1720	1633	43

4. Mark Bracket Positions

As per **Fig.1**. Bracket positions

Width = width of towel rail less 150mm (75mm either side)

Height = Top brackets should be 43mm down from the top of the towel rail (between the 1st and 2nd collector)

Bottom brackets should be 43mm up from the base of the towel rail (between the 1st and 2nd collector from the bottom)

Mark brackets as per **Fig.1**. using a spirit level.

Fig 2. Bracket Assembly

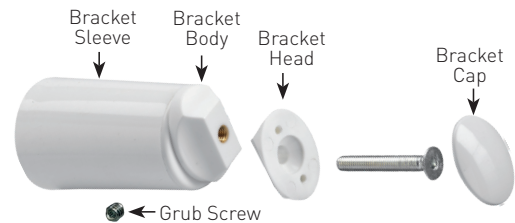

5. Fix Brackets & Hang

1. Fit the Bracket Sleeves (Fig. 2)

Attach the bracket sleeves to the wall using suitable wall fixings (e.g. wall plugs and screws, depending on wall type). Ensure the grub screw on each sleeve is facing downwards.

2. Insert Bracket Bodies

Slide the bracket bodies into the installed sleeves on the wall.

3. Mount the Towel Rail

Lift the towel rail and align it with the bracket bodies. Insert the bracket heads into the top two bracket bodies, then do the same for the lower two bracket bodies. Secure each bracket head in place by tightening the screws provided.

4. Final Adjustments

Make sure the towel rail is vertically aligned. Once aligned, tighten the grub screws on the bracket sleeves to lock everything in place.

5. Finish

Insert the bracket caps to cover the fixings.

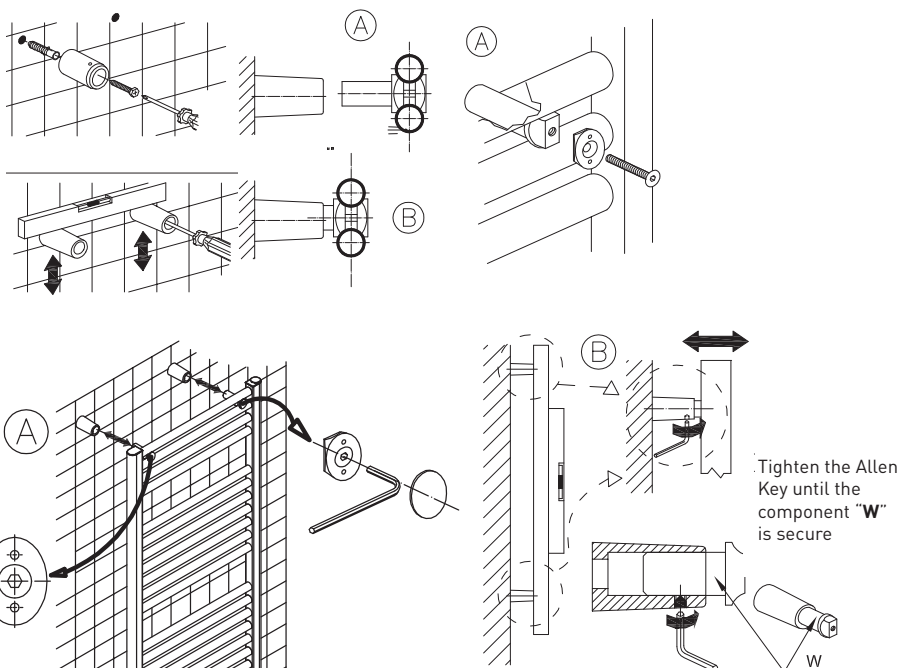

PLEASE NOTE:

It is essential that all brackets are level before hanging the towel rail

6. Commission

Please Note: In accordance with Part L1 2006 of the Building Regulations and BS7593:1992 code of practice for the treatment of hot water and central heating systems, we strongly recommend flushing the heating system post installation of new radiators and then adding the correct quantity and type of inhibitor for use with your radiator and system to prevent corrosion. Damage caused to systems not protected by a suitable inhibitor will not be covered by manufacturer's guarantee.

Technical Specifications

Materials	Mild Steel
Connections	½" flow and return.
Test pressure	10.5 Bar
Testing authority	CE/UKCA approved & certified to BS EN442
Maximum operating pressure	8 Bar
Maximum working temperature	95 °C
Packaging	Wrapped in polyethylene with cardboard box

PLEASE NOTE: Systems using micro bore pipework must have adequate pressure and flow rates for the number and style of radiators on the system

Guarantees & Liabilities

This product is guaranteed for 10 years. The guarantee is subject to the products being installed in accordance with British and or European standards as well as these fitting instructions. The guarantee in all cases are restricted to the free of charge replacement or repair of the failed product only. Our liability will under no circumstances extend beyond the repair or replacement of the product supplied by us. Claims for either labour in replacement or damage to property are not admissible. Any goods that are returned, in the event of a problem, will belong to us.

Terms & Conditions

All products must be inspected once removed from the packaging and your point of purchase notified within 28 days of delivery of any scratches, blemishes or other damage. Your point of purchase will then agree appropriate action.

Imperfect radiators should therefore not be fitted and your point of purchase will not accept responsibility for replacement of scratched or damaged radiators once they have been fitted. This includes any consequential loss or cost of fitting.

If your point of purchase are not notified within 28 days of the date on the signed delivery note then it will be deemed that they have fully complied with their obligations and claims will not be considered.

Failure to comply with any of the above may invalidate any claims. Your point of purchase recommend that after you check the product on delivery that it is stored in its packaging to prevent damage prior to installation, they cannot accept responsibility for items damaged after delivery.